

96500687 CR 20-7 50 Hz

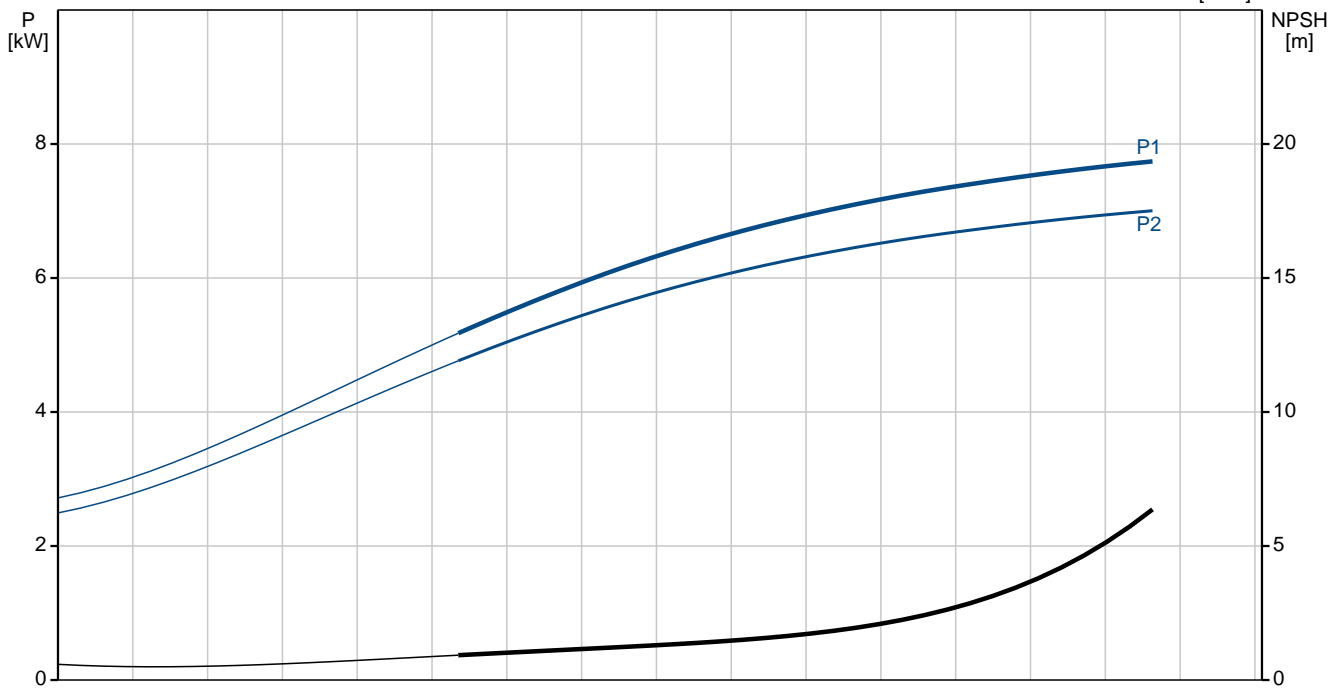

Description	Value
Product name:	CR 20-7 A-A-A-E-HQQE
Product No:	96500687
EAN number:	5700396206912
Price:	On request
Technical:	
Speed for pump data:	2891 rpm
Rated flow:	21 m ³ /h
Rated head:	80.1 m
Head max:	102 m
Impellers:	07
Shaft seal:	HQQE
Approvals on nameplate:	CE, TR
Curve tolerance:	ISO 9906:1999 Annex A
Pump type:	CR 20
Stages:	7
Pump version:	A
Model:	A
Materials:	
Pump housing:	Cast iron EN-JL1030 ASTM A48-30 B
Impeller:	Stainless steel DIN W.-Nr. 1.4301 AISI 304
Material code:	A
Code for rubber:	E
Installation:	
Maximum ambient temperature:	60 °C
Max pressure at stated temp:	10 bar / 120 °C 10 bar / -20 °C
Flange standard:	OVAL
Connect code:	A
Pipe connection:	Rp 2
Flange size for motor:	FF265
Liquid:	
Pumped liquid:	Water
Liquid temperature range:	-20 .. 120 °C
Liquid temp:	20 °C
Density:	998.2 kg/m ³
Kinematic viscosity:	1 mm ² /s
Electrical data:	
Motor type:	132SB
IE Efficiency class:	IE3
Number of poles:	2
Rated power - P1:	7.5 kW
Power (P2) required by pump:	7.5 kW
	7.5 kW
Mains frequency:	50 Hz
Rated voltage:	3 x 200-220 D/346-380 Y V
Rated current:	27,5-26,5/15,8-15,4 A
Starting current:	780-910 %
Cos phi - power factor:	0,88-0,82
Rated speed:	2910-2920 rpm
Efficiency:	IE3 90,1%
Motor efficiency at full load:	90,1-90,4 %
Motor efficiency at 3/4 load:	90,8-90,9 %
Motor efficiency at 1/2 load:	90,8-90,4 %
Enclosure class (IEC 34-5):	55 (Protect. water jets/dust)
Insulation class (IEC 85):	F
Motor protec:	PTC
Motor No:	85904016
Others:	
Label:	Grundfos Blueflux
Minimum efficiency index, MEI :	0.7
Net weight:	103 kg
Gross weight:	125 kg
Shipping volume:	0.43 m ³

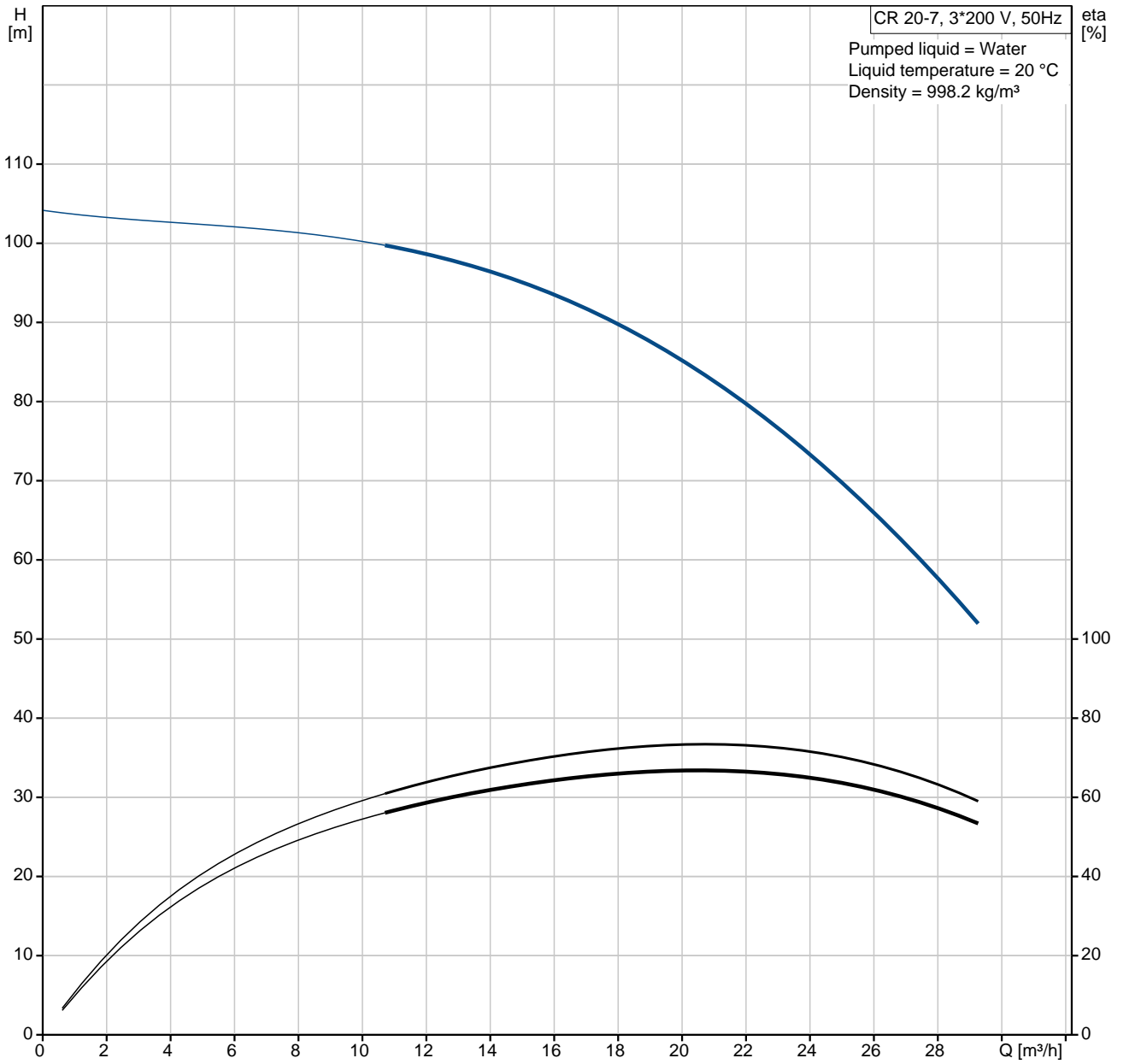
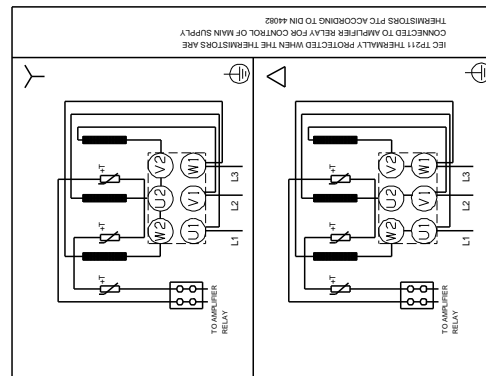
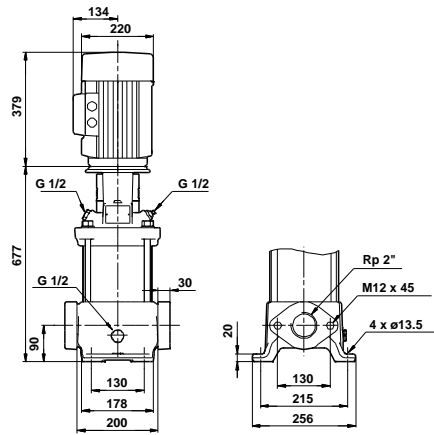
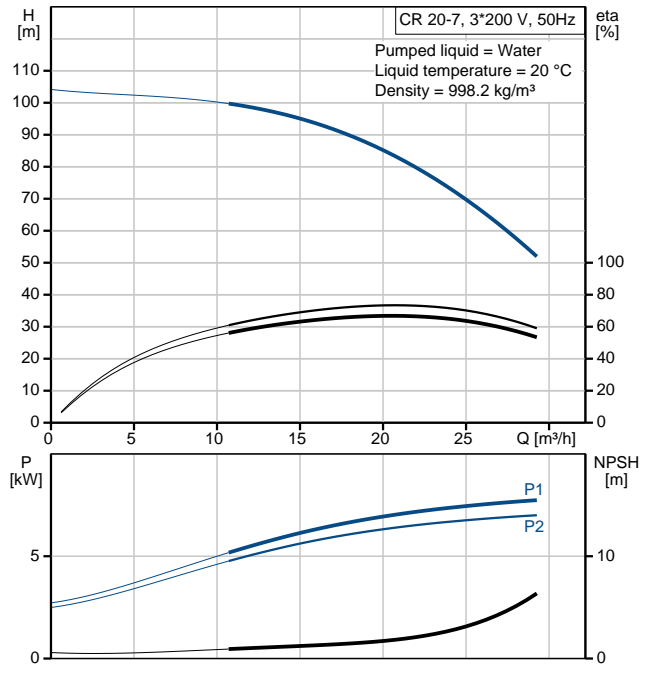

Description

Value

96500687 CR 20-7 50 Hz

CR20-7 + 132SB 7.5 kW 3*200 V, 50 Hz

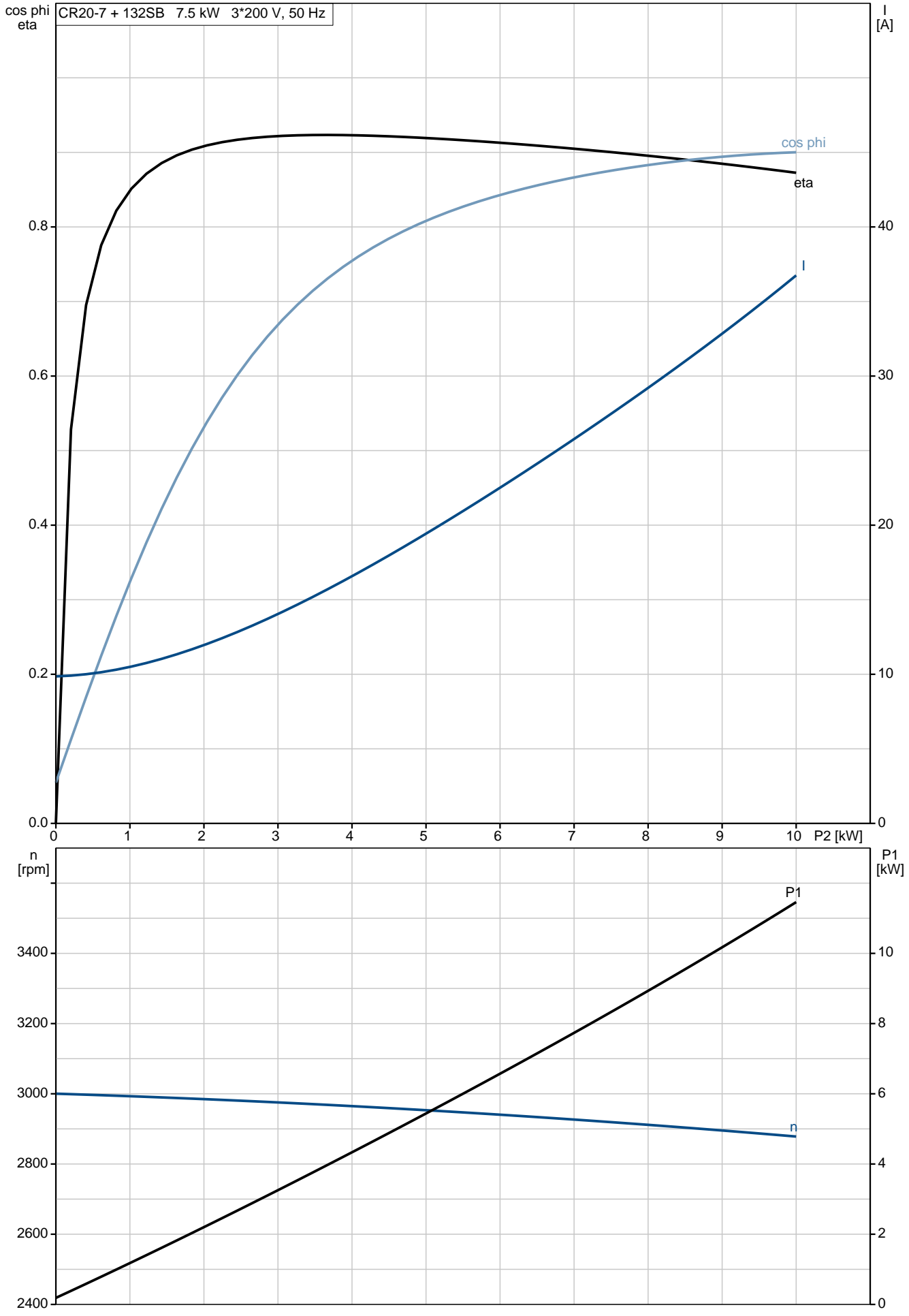

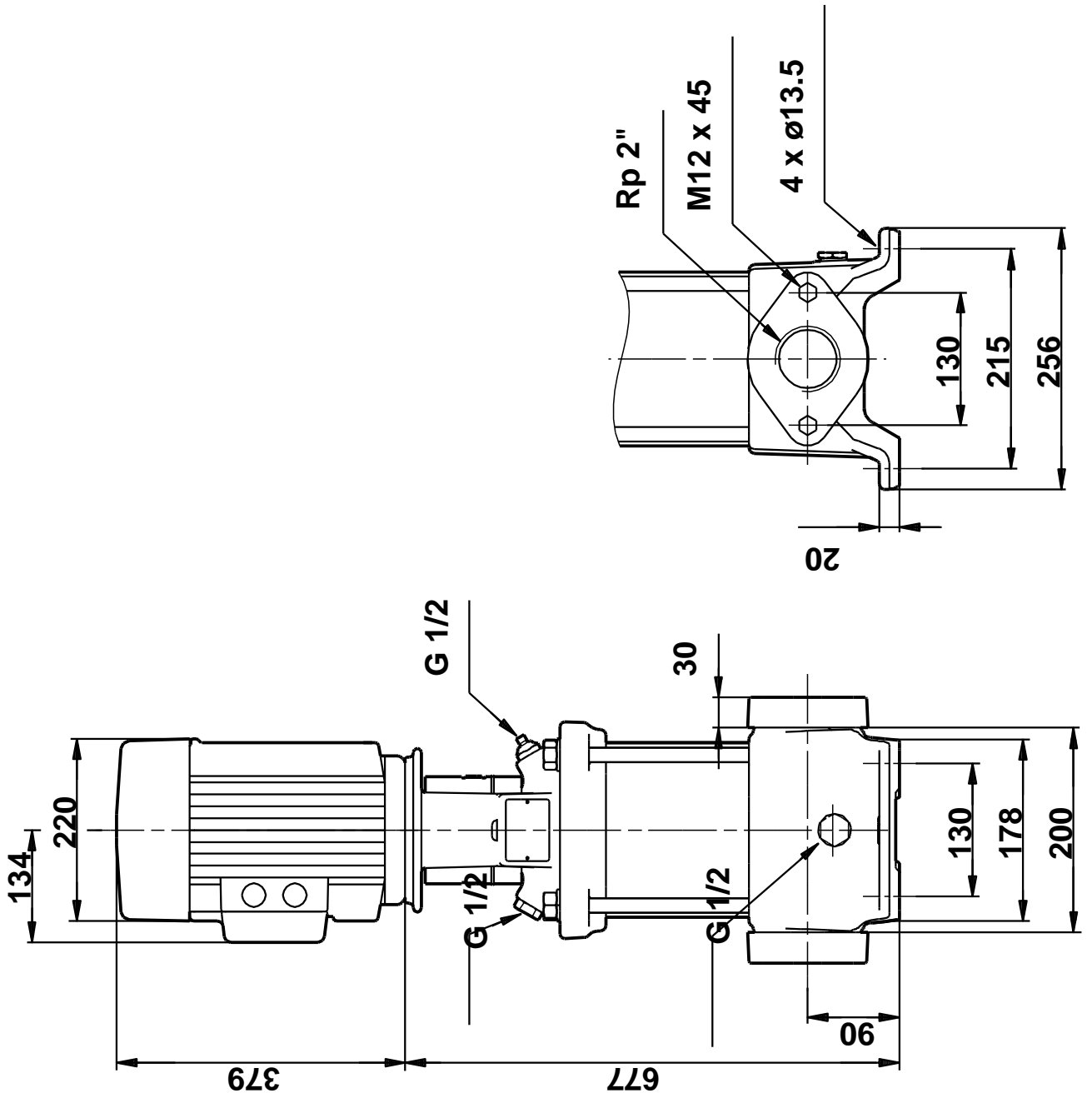

Note! All units are in [mm] unless others are stated.
Disclaimer: This simplified dimensional drawing does not show all details.